

Name: _____

1. A 8 foot board is cut in half, how long will each half be?

$$8 \div 2 = 4 \text{ ft}$$

2. Use a compass and a straight edge to find the midpoint the line below.

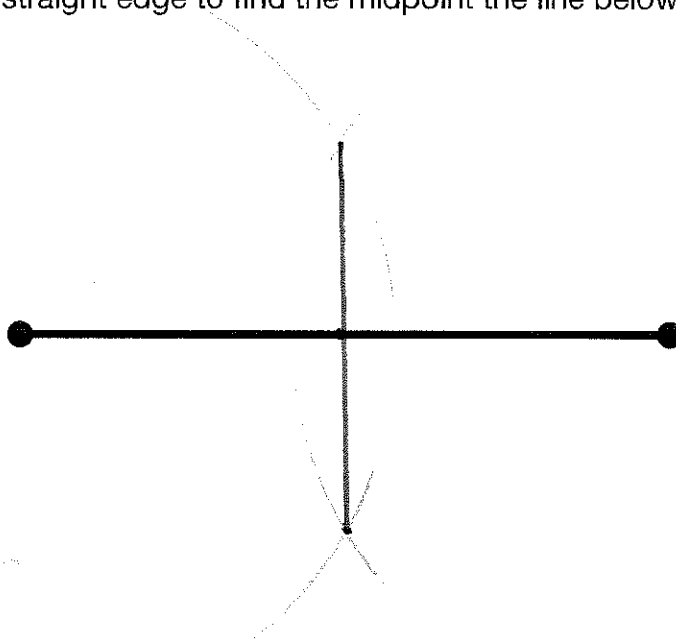

3. Driving from Fort Nelson to Fort St. John, is a distance of 380.7 km.
a) What stop is closest to being a midpoint on the trip? (circle one)

Prophet River which is 91km from Fort Nelson

Bucking horse which is 176 km from Fort Nelson

Pink Mountain which is 229 km from Fort Nelson

Wonowon which is 292 km from Fort Nelson

$$\begin{array}{r} 380.7 \\ \div 2 \\ \hline 190.35 \end{array}$$

- b) How close is you selection to the actual midpoint of the trip?

$$\begin{array}{r} 190.35 \\ - 176 \\ \hline 14.35 \text{ km} \end{array}$$

4. Imagine you were cutting the following line into 3 equal sized pieces. Use a ruler to measure and determine in centimetres how long would each piece be.



$$13.7 \div 3 = 4.57 \text{ cm}$$

5. Jennifer is hanging a picture on a wall, she wants **the centre** of the 26 inch picture to be exactly halfway up an 8 foot wall. The place on the frame the picture will hang from is half an inch from the top of the picture.

0.5 inch

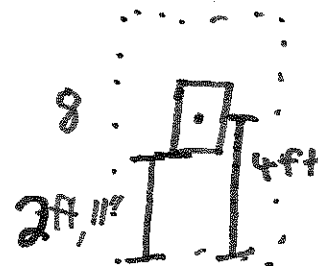
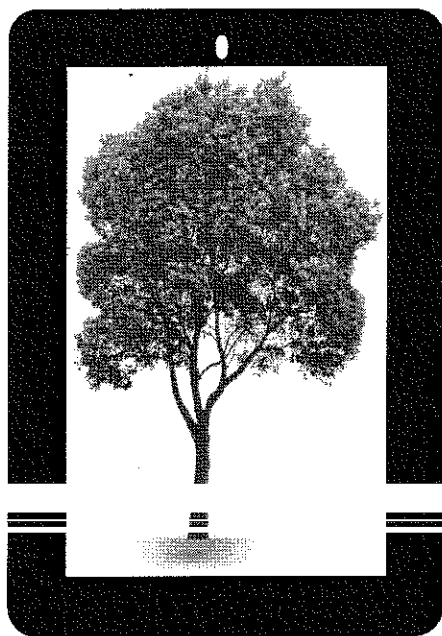

How high up the wall should she put the nail? (Note: the answer is not 4 ft)

$$2 \text{ ft } 11 \text{ inches} + 25.5 \text{ inches}$$
$$2 \text{ ft } 11 \text{ inches} + 2 \text{ ft } 1.5 \text{ inches}$$

$$5 \text{ ft } , 0.5 \text{ inches} \text{ or } 60.5 \text{ inches}$$